

- DO NOT SCALE FROM THIS DRAWING. USE ONLY PRINTED DIMENSIONS
- UTILITY SERVICE INFORMATION SHALL BE OBTAINED AND VERIFIED ON SITE BY THE CONTRACTOR PRIOR TO COMMENCING WORKS.
- GULLY OUTLET PIPES TO BE TIED INTO EXISTING DRAINAGE NETWORK.
- SAW CUTS SHALL BE MADE AT JOINTS BETWEEN EXISTING AND NEW PAVEMENTS. FOR CONSTRUCTION JOINT DETAILS REFER TO DRAWING 10758-STN-00-MD-DR-D-0005.
- A MINIMUM OF THREE ROWS OF TACTILES TO BE PROVIDED FROM THE FACE OF ROAD KERBS AT UNCONTROLLED CROSSINGS UNLESS DETAILED OTHERWISE.
- DRAWING TO BE PRINTED IN COLOUR FOR CLARITY.
- REFER TO DRAWING 10758-STN-00-MD-DR-D-0005 FOR TYPICAL ROAD CONSTRUCTION DETAILS.

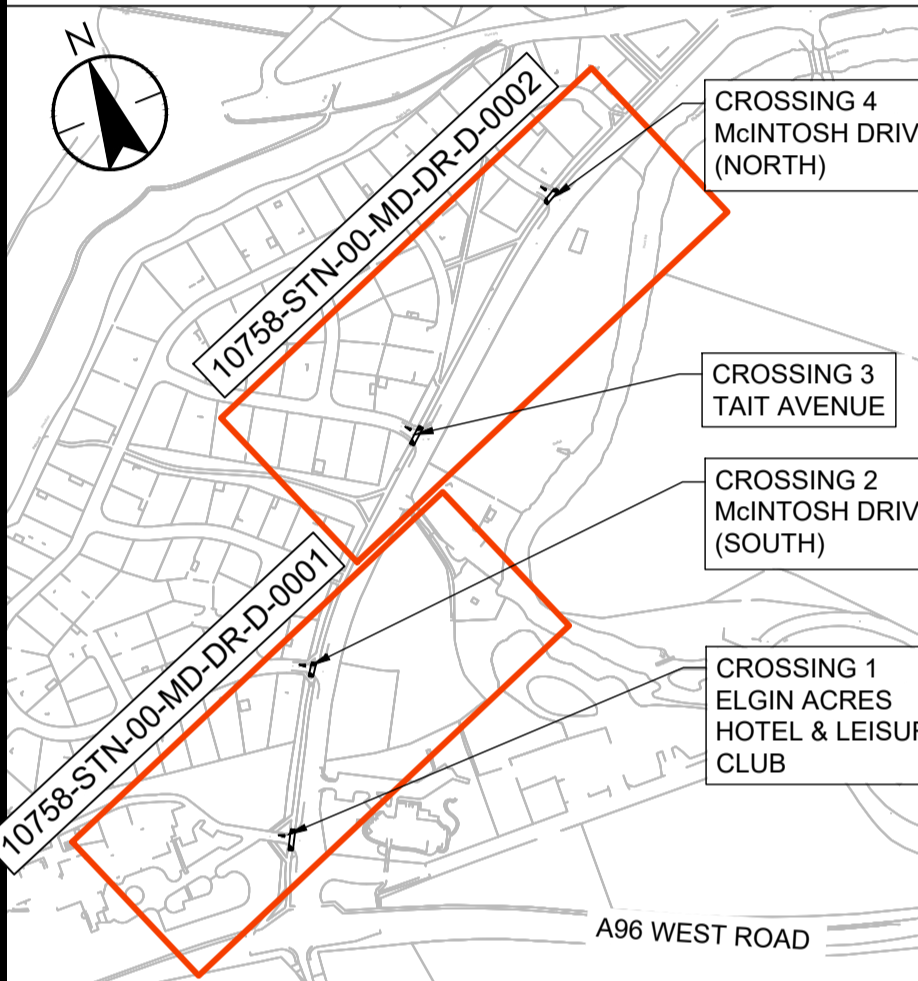

LOCATION

P02 ROAD MARKINGS ADDED				BR	DMcl	2022.09.14
P01 DRAFT ISSUE				DG	DMcl	2022.09.07
Issued/Revision				By	Aspd	YYYY.MM.DD
				DG	DG	BR
				Dwn.	Dsgn.	Chkd.
						2022.09.07
						YYYY.MM.DD

Issue Status

PRELIMINARY

This document is suitable only for the purpose noted above. Use of this document for any other purpose is not permitted.

Client/Project Logo



Client/Project
 MORAY COUNCIL
 CYCLING, WALKING AND SAFER ROUTES

MORRISTON ROAD RAISED TABLES

Title
 GENERAL ARRANGEMENT SHEET 1 OF 2
 MORRISTON ROAD

Project No.	332010758	Scale	AS SHOWN
Revision	P02	Drawing No.	10758-STN-00-MD-DR-D-0001

LEGEND

- PRECAST CONCRETE EDGING KERB - FLUSH E1
- PRECAST CONCRETE HALF BATTER KERB - (HB2)
- BUFF TACTILE PAVING
- NEW GULLY
- RAISED TABLE
- TOPSOIL AND GERMINAL A18 AMENITY GRASS SEED MIX (OR SIMILAR APPROVED)
- SCOTTISH WATER SURFACE DRAIN (SHOWN INDICATIVE BASED ON C2 UTILITY PLANS)

ROAD MARKING SCHEDULE

DIAGRAM NO.	LINE TYPE	SIZE
1003A	GIVE WAY	600mm LINE, 150 GAP, 100mm WIDE
1004	WARNING LINE	400mm LINE, 2000 GAP, 100mm WIDE
1009A	EDGE OF CARRIAGEWAY	600mm LINE, 300mm GAP, 100mm WIDE
1010	EDGE OF CARRIAGEWAY	1000mm LINE, 1000mm GAP, 100mm WIDE
1023A	GIVE WAY TRIANGLE	3750mm LONG, 1250mm WIDE
1062	TRIANGULAR MARKING	900mm LONG, 750mm WIDE

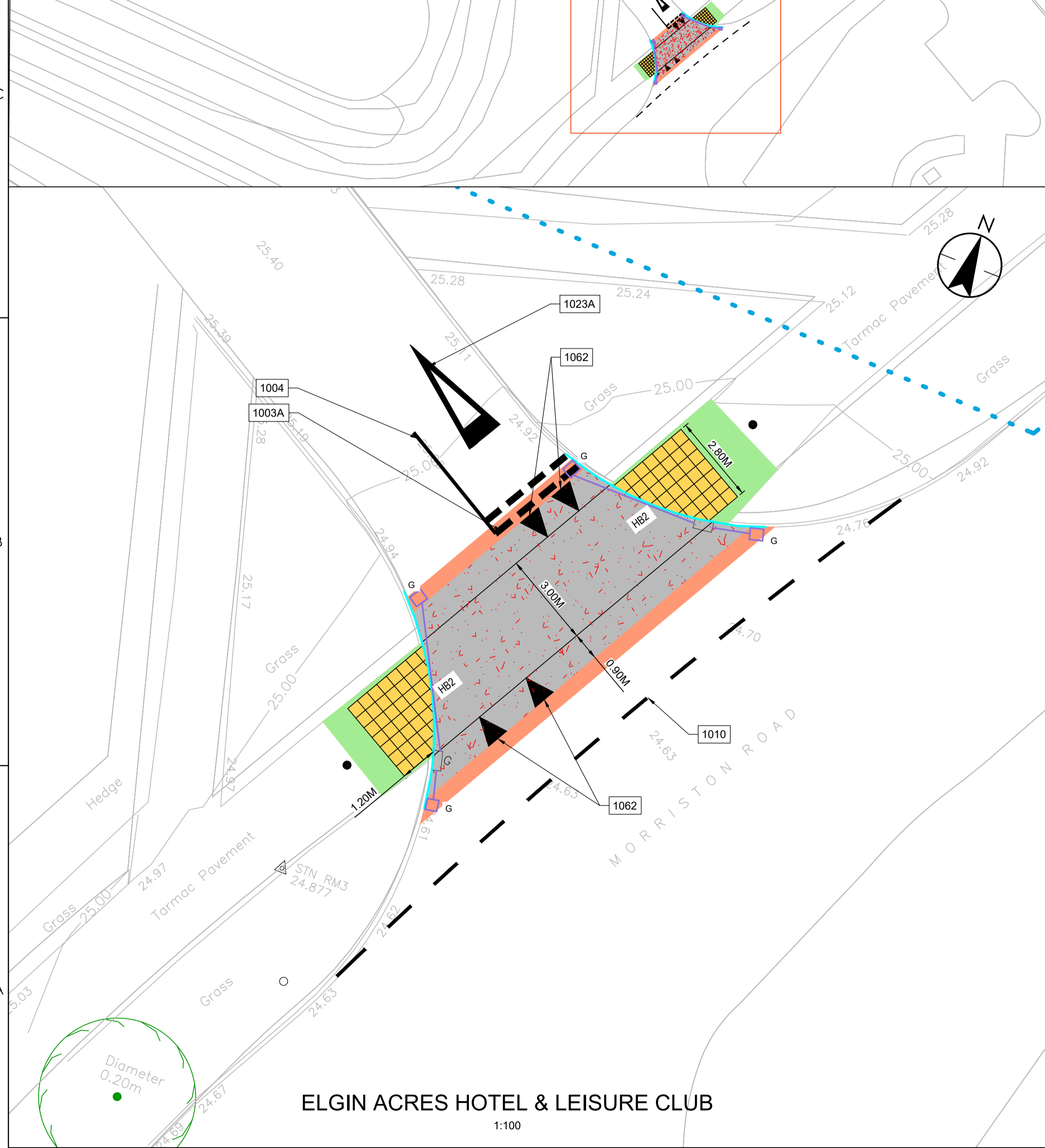

VIEWPORT 1
 1:500

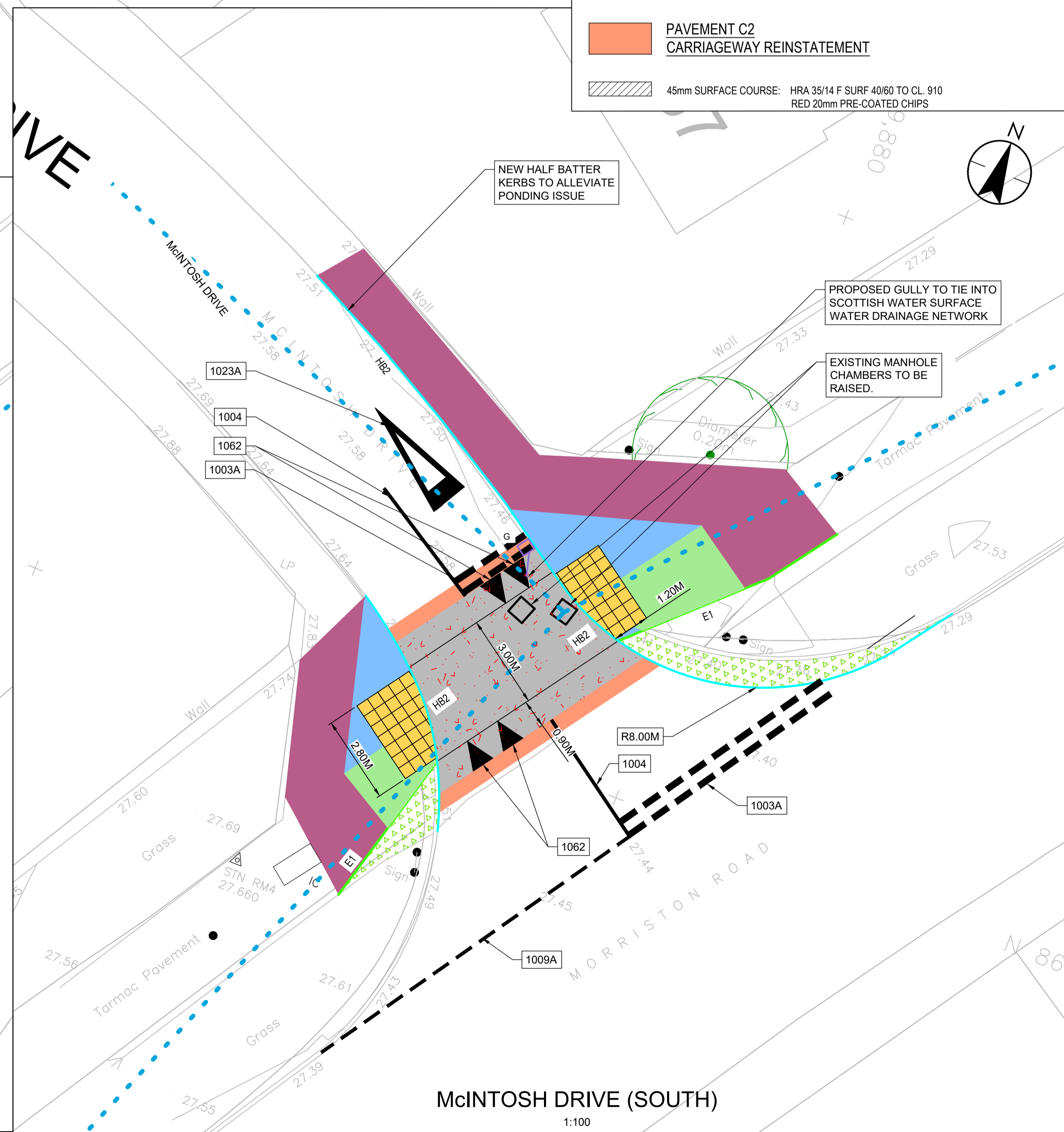

FOOTWAY F1
 NEW FOOTWAY CONSTRUCTION

60mm SURFACE COURSE: AC 10 CLOSE SURF 100/150 TO CL. 912
 150mm SUB-BASE: TYPE 2 TO CL. 804

FOOTWAY F2
 FOOTWAY RESURFACING

30mm SURFACE COURSE: AC 6 DENSE SURF 100/150 TO CL. 909
 20mm REGULATING COURSE: AC 20 DENSE BIN 40/60 REC. TO CL. 906

PAVEMENT C1
 CARRIAGEWAY TO RAISED TABLE CONSTRUCTION

45mm SURFACE COURSE: HRA 35/14 F SURF 40/60 TO CL. 910
 30mm REGULATING COURSE: AC 20 DENSE BIN 40/60 REC. TO CL. 906

ASPHALT FOR RAISED TABLE TO OVERLAY EXISTING CARRIAGEWAY UNLESS SITE INSPECTION DETERMINES SURFACE IS UNSUITABLE AND MILLING OUT AND PLACEMENT OF REGULATING COURSE IS NECESSARY TO PROVIDE SUITABLE SURFACE TO LAY NEW ASPHALT.

FOOTWAY F3
 FOOTWAY DISH REINSTATEMENT

60mm SURFACE COURSE: AC 6 DENSE SURF 100/150 TO CL. 909
 0-40mm REGULATING COURSE: AC 20 DENSE BIN 40/60 REC. TO CL. 906

PAVEMENT C2
 CARRIAGEWAY REINSTATEMENT

45mm SURFACE COURSE: HRA 35/14 F SURF 40/60 TO CL. 910
 RED 20mm PRE-COATED CHIPS